

# AG11, AG12

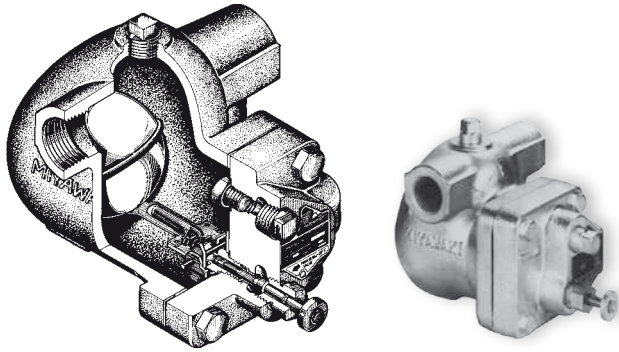

Capacity Chart AG11, AG12

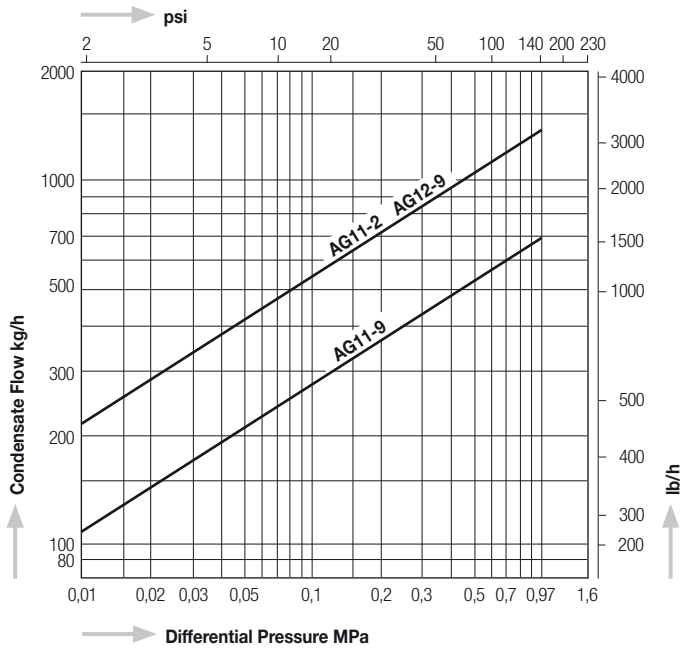

# AGC1V

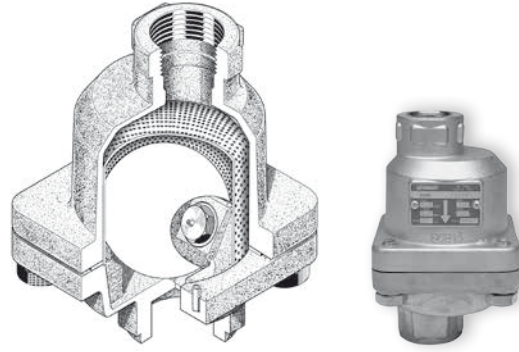

Capacity Chart AGC1V

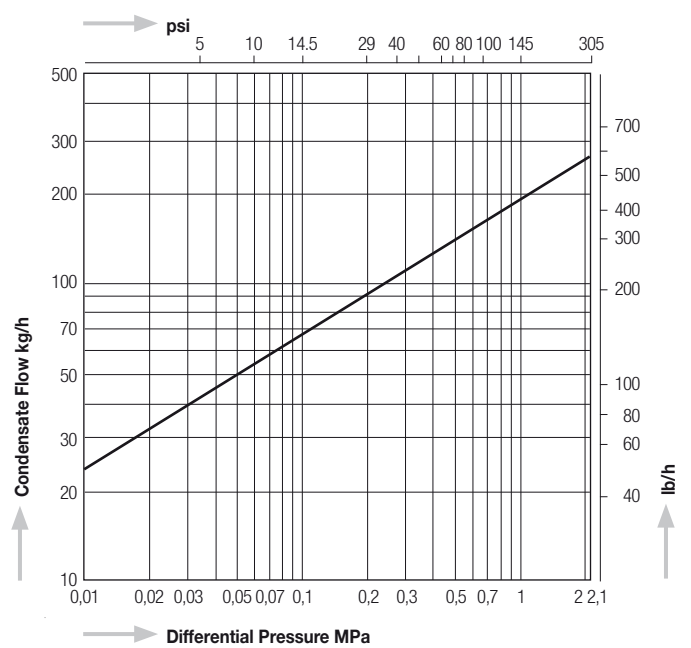

Dimensions AG11, AG12

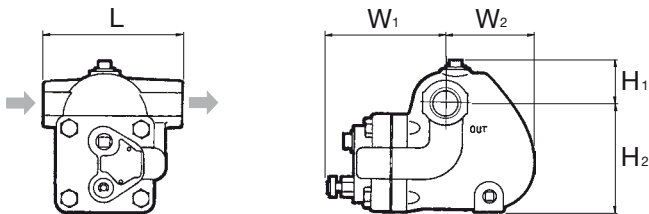

Dimensions AGC1V, AGC1V-W, AGC1V-F

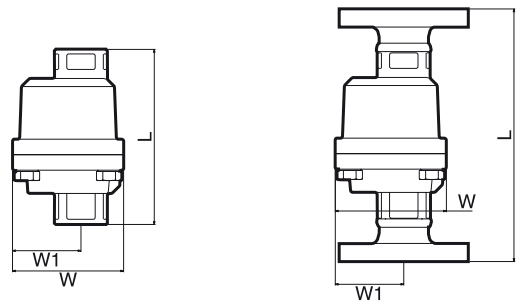

Model	Connections	Size (in)	Max. Operating Pressure		Max. Operating Temperature		Dimensions (mm)						Dimensions (in)					Body Material	Weight		
			MPa	psig	°C	°F	L	H1	H2	W1	W2	W	L	H1	H2	W1	W2		W	kg	lb
AG11 - 2	Screwed Rc, NPT	½", ¾"	0,01 - 0,2	1.5 - 29	100	212	120	37	92	121	60	-	4.7	1.5	3.6	4.8	2.4	-	Cast Iron FC250	3,9	8.6
AG12 - 9		¾", 1"	0,01 - 0,97	1.5 - 140			140	47	113	129	92	-	5.5	1.9	4.4	5.1	3.6	-		5,9	13.0
AGC1V	Screwed Rc, NPT	½"	0,01 - 2,1	1.5 - 305	350	662	127	-	-	53	-	86	5.0	-	-	2.1	-	3.4	Stainless Steel SCS13A	1,8	4.0
		¾"					136						5.4							1,9	4.2
		1"					140						5.5							2,0	4.4
AGC1V-W	Socket Weld JIS, ASME, DIN	½"	0,01 - 2,1	1.5 - 305	350	662	127	-	-	53	-	86	5.0	-	-	2.1	-	3.4	Stainless Steel SCS13A	1,8	4.0
		¾"					136						5.4							1,9	4.2
		1"					140						5.5							2,0	4.4
AGC1V-F	Flanged JIS, ASME, DIN	½"	0,01 - 2,1	1.5 - 305	350	662	175	-	-	53	-	86	6.9	-	-	2.1	-	3.4	Stainless Steel SCS13A	3,3	7.3
		¾"					195						7.7							4,5	9.9
		1"					215						8.5							5,3	11.7