

# AGH12, AGH50

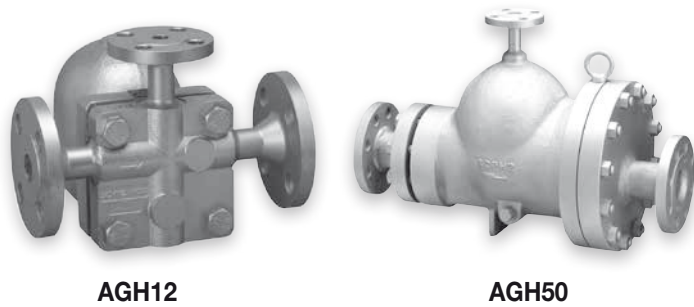

Capacity Chart AGH12-45

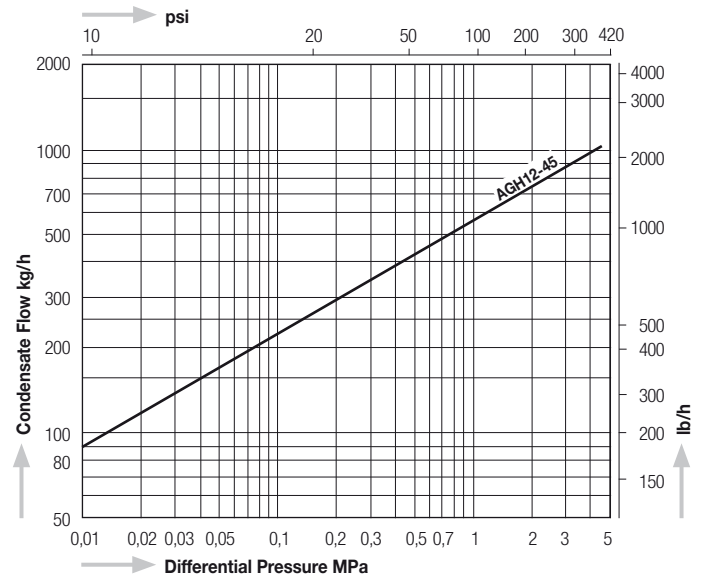

Dimensions

AGH12-45F

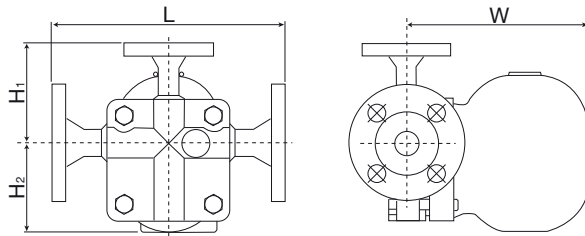

AGH12-45W

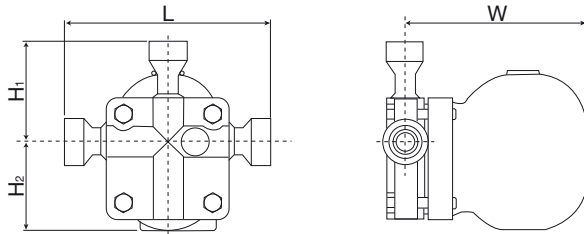

AGH50

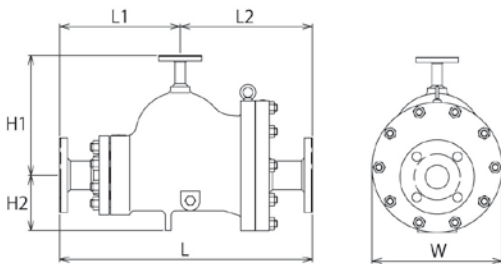

Capacity Chart AGH50

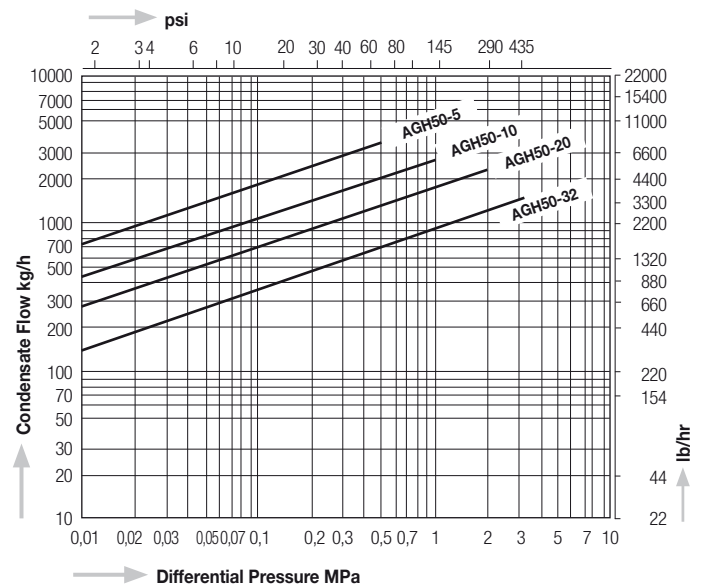

Table 1: Dimensions L and Weight

Model	Connections	ASME Class* (#150, #300)							
		Dimensions* (mm)			Dimensions* (in)			Weight*	
		L	L <sub>1</sub>	L <sub>2</sub>	L	L <sub>1</sub>	L <sub>2</sub>	kg	lb
AGH50	2"	525	250	275	20,7	9,8	10,8	64	140,8
	2½"	550	265	285	21,7	10,4	11,2	68	149,6
	3"	555		290	21,9	10,4	11,4	72	158,4
	4"	590	285	305	23,2	11,2	12,0	73/82	160,6/180,4

Model	Connections	Size (in)	Max. Operating Pressure		Max. Operating Temperature		Dimensions* (mm)					Dimensions* (in)					Body Material	Weight*				
			MPa	psig	°C	°F	L	L <sub>1</sub>	L <sub>2</sub>	H <sub>1</sub>	H <sub>2</sub>	W	L	L <sub>1</sub>	L <sub>2</sub>	H <sub>1</sub>		H <sub>2</sub>	W	kg	lb	
AGH12 - 45F	Flanged JIS, ASME, DIN	½" - 1"	4,5	652	425	800	250			107	95	195	9.8				4.2	3.7	7.7	Cast Steel SCPH2	17	37.4
AGH12 - 45W	Socket Weld ASME, DIN									75											8.7	12
AGH50 - 5 10 20 32	Flanged JIS, ASME, DIN	2" - 4"	3,2	464	400	752	Table 1			250	115	270	Table 1			9.8	4.5	10.6	Cast Steel SCPH2	Table 1		

\* Depending on the flange standard the face-to-face dimensions and the weight may differ.