

Steam Traps with Two-bolt Connection

DC1-21U

Balanced Pressure Thermostatic Type



SU2-32U

Thermodynamic Type



All types:

With stainless steel body and stainless steel internals. For horizontal and vertical installation. Two-bolt connection for simplified replacement of the steam trap.

Capacity Chart DC1-21U

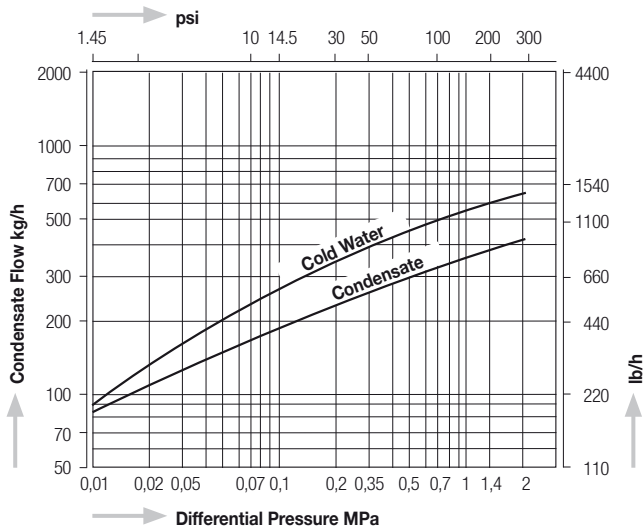

Capacity Chart SU2-32U

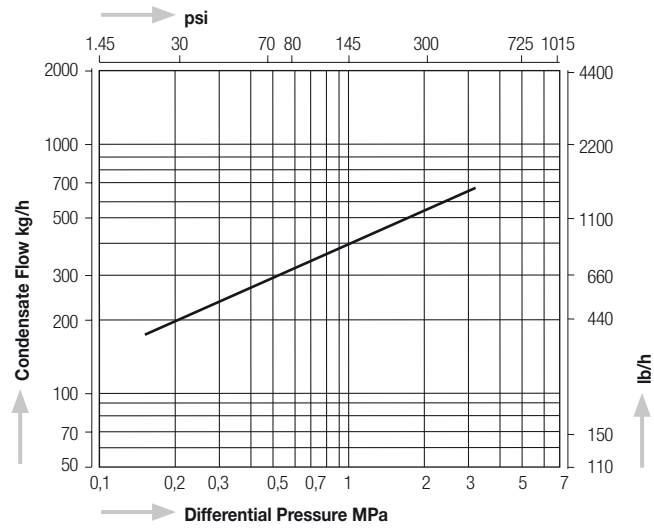

Dimensions

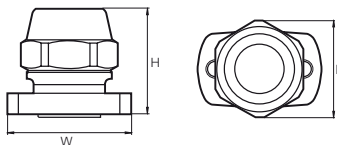

Dimensions

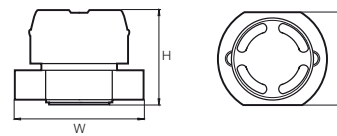

Model	Connection	Max. Operating Pressure		Max. Operating Temperature		Dimensions (mm)			Dimensions (in)			Body Material	Weight	
		MPa	psig	°C	°F	D	H	W	D	H	W		kg	lb
DC1-21U	Universal Two-bolt Connection	2,1	305	235	455	55	62	70	2.2	2.4	2.8	Stainless Steel CF8M	0,8	1.8
SU2-32U		3,2	464	350	662	60	55	70	2.4	2.2	2.8		0,8	1.8

UNC

Connector Body for Models: DC1-21U & SU2-32U

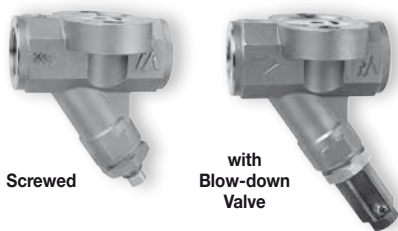

Dimensions

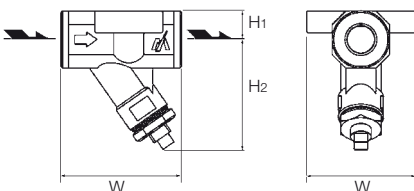

VB1, VB1R

Blow-down Valve

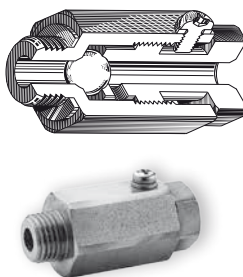

Dimensions

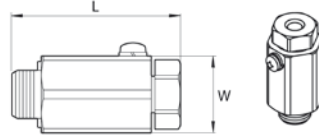

Capacity Chart

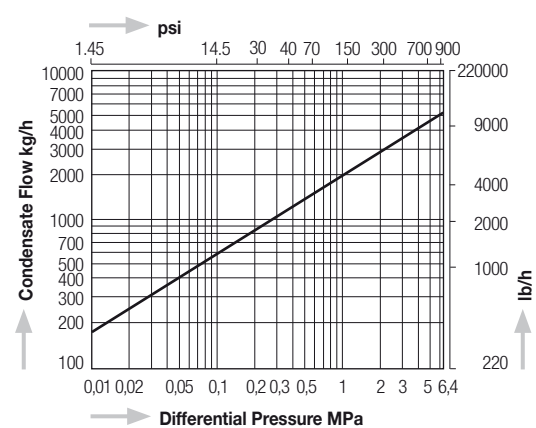

Model	Connection	Size in	Max. Operating Pressure		Max. Operating Temperature		Dimensions (mm)				Dimensions (in)				Body Material	Weight	
			MPa	psig	°C	°F	L	H1	H2	W	L	H1	H2	W		kg	lb
UNC	Screwed & Socket Weld	½"	3,2	464	400	752	80	19	73	72	3.15	0.75	2.9	2.8	Stainless Steel A351CF8M	1,0	2.2
UNC-W		¾"															
VB1	Screwed G	¼"	6,4	928	425	800	46			25	1.8			1.0	Stainless Steel SUS304	0,08	0.18
VB1R	Screwed R										2.0						

AW2

AT9N

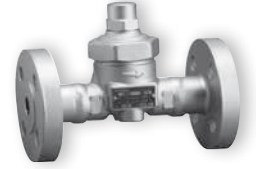
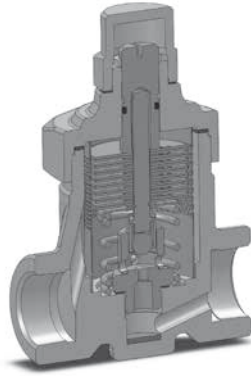
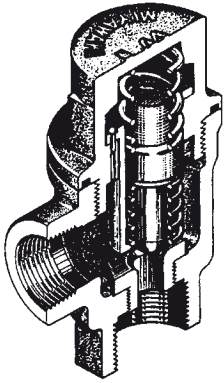

Screwed & Socket weld

Flanged Connection

Dimensions

AW2

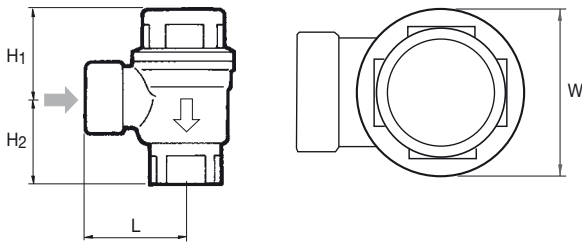

Dimensions

AT9N • AT9NW

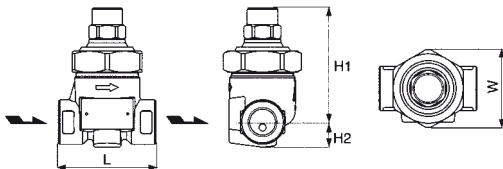

AT9NF

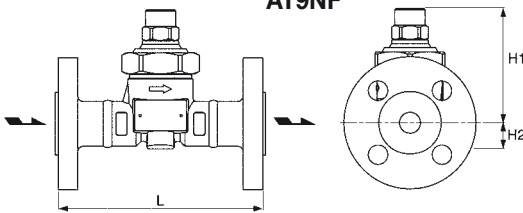

AW2

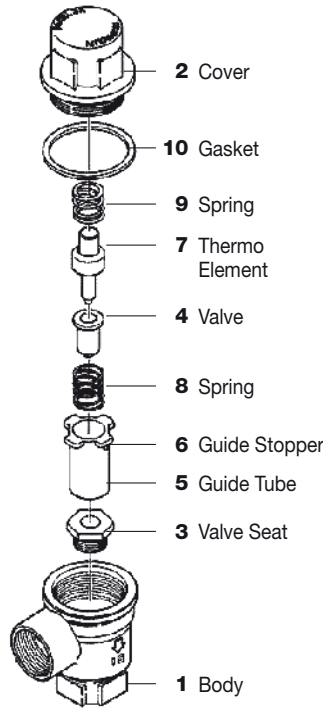

AT9N

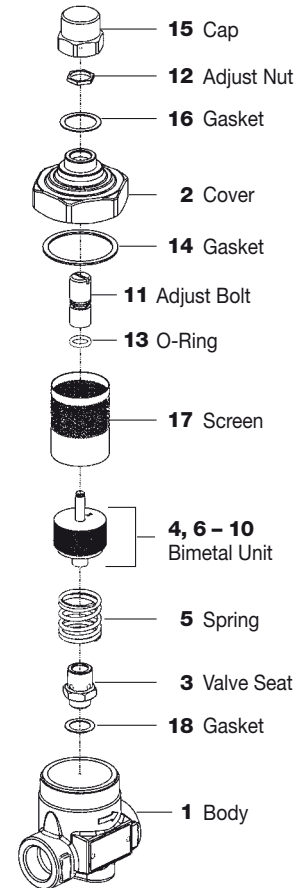

Model	Connections	Size (in)	Max. Operating Pressure		Max. Operating Temperature		Adjustable Range		Dimensions (mm)				Dimensions (in)				Body Material	Weight	
			MPa	psig	°C	°F	°C	°F	L	H1	H2	W	L	H1	H2	W		kg	lb
AW2-5	Screwed Rc, NPT	1/2"	0,5	73	160	320	-	-	35	39	35	41	1.4	1.5	1.4	1.6	Brass C3771	0,4	1.0
		3/4"									41				1.6			0,5	1.1
AT9N	Screwed Rc, NPT	1/2"	1,6	230	350	662	50 - 180	122 - 356	70	82	18	56	2.75	3.2	0.7	2.2	Forged Steel A105	0,9	2.0
		3/4"									19				0.75			1,0	2.2
		1"									23				0.9			1,1	2.4
AT9NW	Socket Weld ASME, DIN	1/2"	1,6	230	350	662	50 - 180	122 - 356	70	82	18	56	2.75	3.2	0.7	2.2	Forged Steel A105	0,9	2.0
		3/4"									19				0.75			1,0	2.2
		1"									23				0.9			1,1	2.4
AT9NF	Flanged JIS, ASME, DIN	1/2"	1,6	230	350	662	50 - 180	122 - 356	145*	82	18	56	5.7*	3.2	0.7	2.2	Forged Steel A105	2,6	5.7
		3/4"									19				0.75			3,4	7.5
		1"									23				0.9			4,0	8.8

*On request also available with different face-to-face length

MK

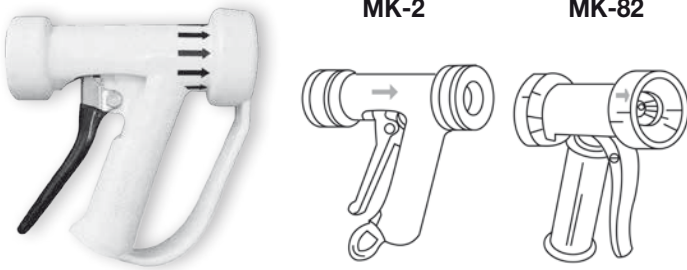

Model	Material	Rubber Cover	Trigger	Orifize Size		Maximum Pressure	
				in	mm	MPa	psi
MK-2	Gunmetal or Stainless Steel	Black or White	rear	5/16"	7,9	2,8	406,0
MK-OH				7/16"	11,1		
MK-MV				9/16"	14,3	0,7	101,5
MK-78	Gunmetal	Black or White	front	5/16"	7,9	1,4	203,0
MK-80				7/16"	11,1		
MK-82				9/16"	14,3	0,7	101,5

Pressure		Orifize Size			Orifize Size		
		5/16"	7/16"	9/16"	5/16"	7/16"	9/16"
MPa	psig	l/min			GPM		
0,035	5,0	3,2	13,5	15,0	0,84	3,56	3,96
0,07	10,2	5,6	20,0	21,0	1,48	5,28	5,54
0,1	14,5	7,0	22,5	24,0	1,85	5,94	6,34
0,2	29,0	10,0	25,0	36,0	2,64	6,60	9,50
0,3	43,5	12,5	32,0	47,0	3,30	8,45	12,41
0,35	50,8	14,5	37,0	52,0	3,83	9,77	13,73
0,4	58,0	16,0	38,0	55,0	4,22	10,03	14,52
0,5	72,5	18,0	40,0	60,0	4,75	10,56	15,84
0,6	87,0	20,5	42,0	65,0	5,41	11,09	17,16
0,7	101,5	22,3	44,0	69,0	5,89	11,62	18,22
1,0	145,0	27,5	51,0	-	7,26	13,46	-
1,5	217,5	35,0	62,0	-	9,24	16,37	-
2,0	290,0	43,0	74,0	-	11,35	19,54	-
2,5	362,5	50,5	85,0	-	13,33	22,44	-

Features

1. Trigger operated water gun. Front trigger or rear trigger available
2. Perfect water consumption control
3. One-handed mode with either variable spray or direct jet
4. Automatic and immediate shut-off when the trigger is released

Suitable for

MK2 is suitable for most industrial applications
MK-MV is recommended for use with Steam-Water-Mixing Valves

CVC3, CVC3R, CV5R Check Valve

CVC3, CVC3R, CV5R



Pressure Drop Chart

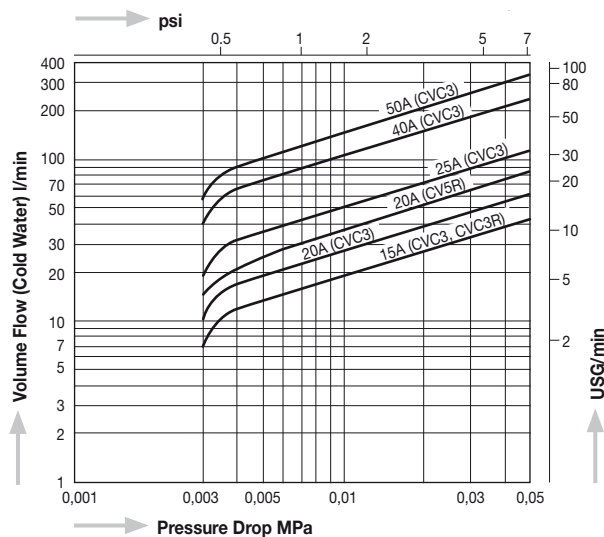

Dimensions

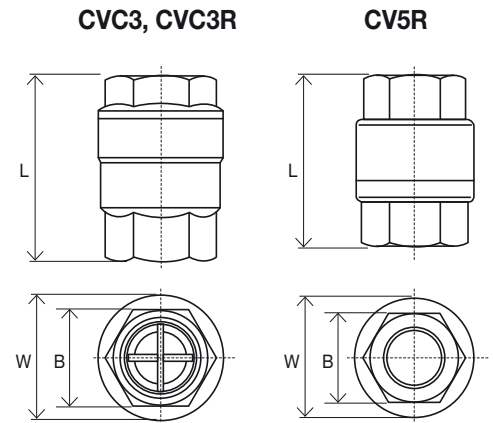

Model	Connections	Size (in)	Max. Operating Pressure		Opening Pressure		Max. Operating Temperature		Dimensions (mm)			Dimensions (in)			Body Material	Weight	
			MPa	psig	MPa	psig	°C	°F	L	W	B	L	W	B		kg	lb
CVC3	Screwed Rc, NPT	1/2"	2,1	305	0,003	0,44	220	428	48	35	27	1,9	1,4	1,1	Stainless Steel SCS13A	0,2	0,44
		3/4"							61	43	33	2,4	1,7	1,3		0,3	0,66
		1"							73	54	41	2,9	2,1	1,6		0,6	1,32
		1 1/2"							87	75	58	3,4	3,0	2,3		1,2	2,64
		2"							100	90	72	3,9	3,5	2,8		1,8	3,96
CVC3R	Screwed Rc, NPT	1/2"	2,1	305	0,003	0,44	80	176	48	35	27	1,9	1,4	1,1	SCS13A	0,2	0,44
CV5R	Screwed Rc, NPT	3/4"	1,6	230	0,003	0,44	80	176	60	46	34	2,4	1,8	1,3	SCS13A	0,3	0,66

Y



Dimensions YM1

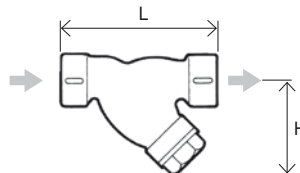

YSF-W

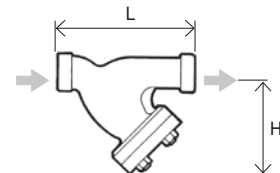

Model	Connections	Size (in)	Max. Operating Pressure		Max. Operating Temperature		Mesh	Dimensions (mm)		Dimensions (in)		Body Material	Weight	
			MPa	psig	°C	°F		L	H	L	H		kg	lb
YM1	Screwed Rc, NPT	1/2"	2,0	290	220	428	60	75	55	3.0	2.2	Ductile Cast Iron	0,5	1.1
		3/4"						90	70	3.5	2.8		0,9	2.0
		1"						110	85	4.3	3.3		1,4	3.1
YSF-W	Socket Weld	1/2" - 1"	4,9	710	425	797	60	140	125	5.5	4.9	Forged Steel A105	5,0	11.0
		1 1/4" - 2"						190	170	7.5	6.7	Forged Steel S25C	9,5	20.9

Vacuum Breaker CV11, CVU15

CV11, CVU15



Capacity Chart CVU15

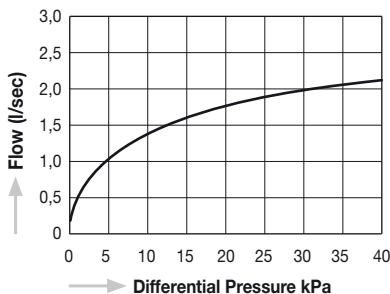

Dimensions

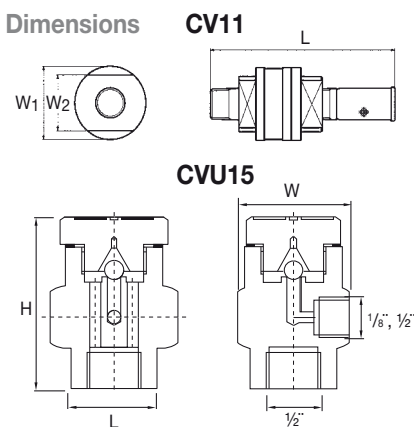

Model	Connections		Size (in)	Max. Operating Pressure		Max. Operating Temperature		Dimensions (mm)					Dimensions (in)					Body Material	Weight				
				MPa	psig	°C	°F	L	H	W	W1	W2	L	H	W	W1	W2		kg	lb			
CV11	Male thread R		1/2"	0,9	130	150	302	130											Stainless Steel SUS304	0,8	1.8		
			3/4"					135															
			1"					135															
CVU15	System connection	Air inlet connection	1/2" x 1/8"	2,1	305	450	842	55										Stainless Steel AISI 304 (DIN 1.4301)	0,38	0.84			
	1/2" Screwed (BSP, BSPT, NPT)	1/8", 1/2" Screwed (BSP, BSPT, NPT)	1/2" x 1/2"					32															
								70															

Anti-Freezing Valve F1

F1

Features

1. Easy installation: compact in size
2. No adjustment
3. Easy maintenance

Suitable for

Discharge of remaining condensate out of steam traps and pipe lines

Capacity Chart F1

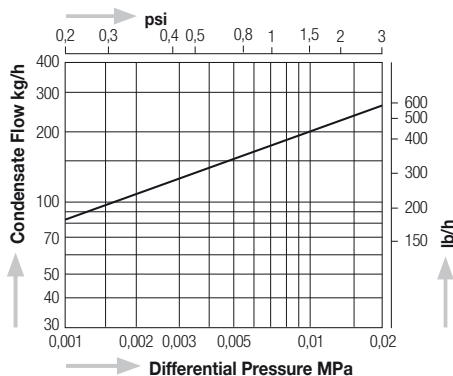

Dimensions F1B

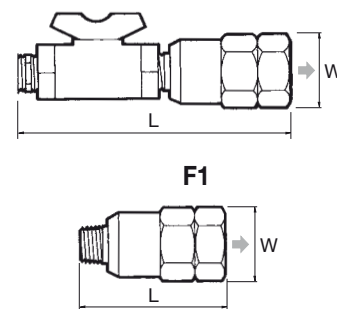

Model	Connection	Size (in)	Max. Operating Pressure		Working Pressure				Max. Operating Temperature		Dimensions (mm)		Dimensions (in)		Body Material	Weight	
			MPa	psig	Opening		Closing		°C	°F	L	W	L	W		kg	lb
					MPa	psig	MPa	psig									
F1B	Screwed Rc, NPT	1/4"	1,0	145	0,01 - 0,04	1.5 - 5.8	0,02 - 0,05	2.9 - 7.3	220	428	105	27	4.1	1.1	Brass C3771	0,19	0.42
		3/8"									110		4.3			0,23	0.51
F1		1/4", 3/8"	1,6	230							52		2.0			0,13	0.29

TS1



Features

To check operation of steam traps

Suitable for

Steam and liquid lines

T3



Dimensions TS1

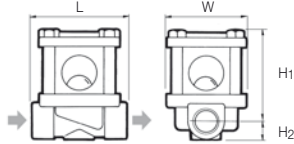

T3

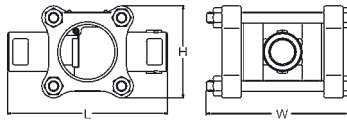

T3F

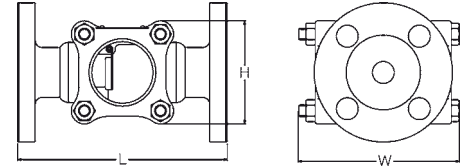

Model	Connect.	Size (in)	Max. Operating Pressure		Max. Operating Temperature		Dimensions (mm)					Dimensions (in)					Body Material	Weight			
			MPa	psi	°C	°F	L	H	H ₁	H ₂	W	L	H	H ₁	H ₂	W		kg	lb		
TS1	Screwed	1/2"	0,8 Steam	116 Steam	180 Steam	356 Steam	80	69	14	60	3.1	2.7	0.5	2.4	Brass C3771	0,9	1,8				
		3/4"	1,0 Water	145 Water	100 Water	212 Water										71	17	2,8	0,7	1,0	2,0
		1"	0,97 Air	140 Air	100 Air	212 Air										85	76	3,0	0,8	1,2	2,2
T3	Screwed	1/2"	1,0	145	183	361	123	70	110	4.8	2.8	4.3	Cast Steel A216WCB	1,6	3,5						
		3/4", 1"												1,7	3,7						
		1 1/4"												3,3	7,3						
		1 1/2"											3,2	7,0							
2"	7,3	16,1	Cast Iron FC200	7,3	16,1																
T3F	Flanged	1/2"	1,0	145	183	361	144	70	110	5.7	2.8	4.3	Cast Steel A216WCB	3,3	7,3						
		3/4"												4,4	9,7						
		1"												5,0	11,0						
		1 1/4"											8,0	17,6	Cast Iron FC200	9,0	19,8				
		1 1/2"											9,0	19,8							
2"	12,0	26,4																			

Spare Parts

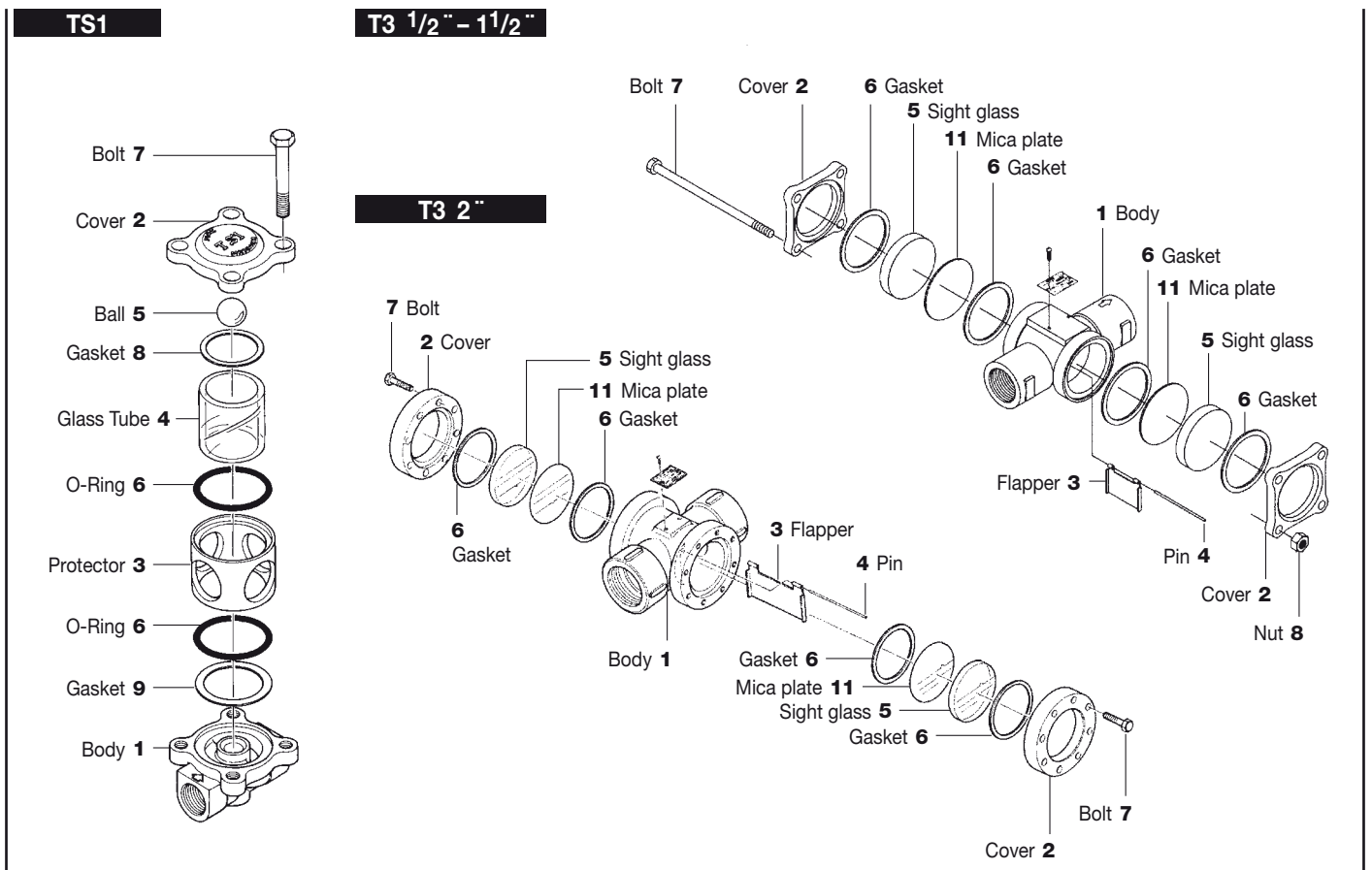

H3

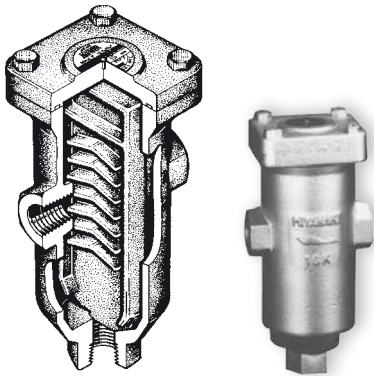

H5



H9XF

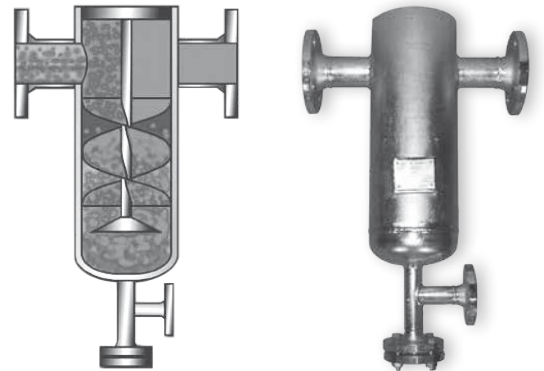

Features

1. Separates mist, condensate from steam and/or air lines
2. Compact size – easy installation together with Pressure Reducing Valves and Steam Traps
3. Very low pressure loss (0,002 MPa)

Suitable for

All steam and air lines

Dimensions

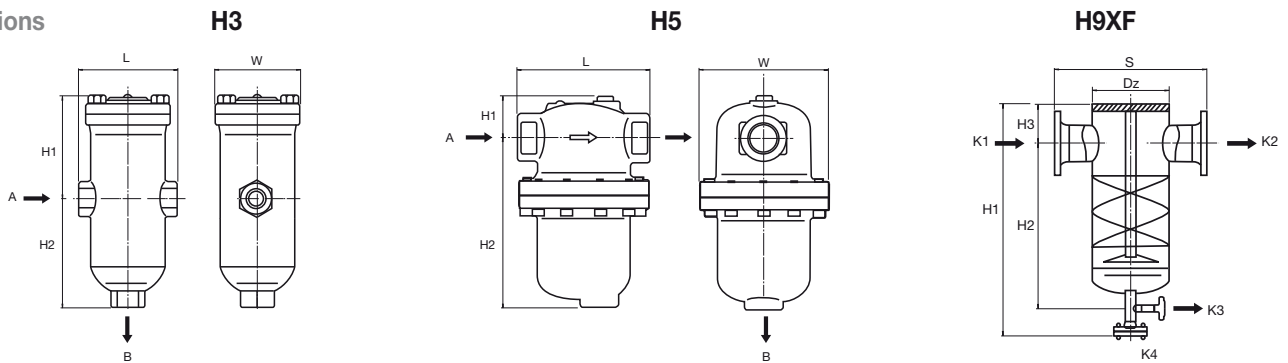

Model	Connections	Size (in)		Max. Operating Pressure		Max. Operating Temperature		Dimensions (mm)				Dimensions (in)				Body Material	Weight		
		A	B	MPa	psig	°C	°F	L	H ₁	H ₂	W	L	H ₁	H ₂	W		kg	lb	
H3	Screwed Rc, NPT	1/2"	1/2"	1,6	230	220	428	100	93	120	86	3.9	3.7	4.7	3.4	Ductile Cast Iron FCD450	3,6	7.9	
		3/4"	1/2"					130	120	158	108	5.1	4.7	6.2	4.3		6,7	14.7	
		1"	1/2"					160	130	180	128	6.3	5.1	7.1	5.0		10,1	22.2	
H5	Screwed Rc, NPT	1/2"	3/4"	2,0 (Air: 0,97)	290 (Air: 141)	220	428	150	50	193	146	5.9	2.0	7.6	5.7	Ductile Cast Iron FCD450	7,1	15.6	
		1"						190	69	213	175	7.5	2.7	8.4	6.9		7,3	16.1	
		1 1/4"						219	82	260	199	8.6	3.2	10.2	7.8		12,5	27.5	
		1 1/2"																	
		2"																	

Model	Connect.	Size (DN)	PN	Inlet	Outlet	Condens. Outlet	Dirt Pocket	Dimensions (mm)					Dimensions (in)					Body Material	Weight	
				K ₁ (DN)	K ₂ (DN)	K ₃ (DN)	K ₄ (DN)	Dz	H ₁	H ₂	H ₃	S	Dz	H ₁	H ₂	H ₃	S		kg	lb
H9XF	Flanged DIN, ASME	15	16	15	15	15	15	88,9	360	240	50	240	3.5	14.2	9.4	2.0	9.4	Steel P235 GH	6,8	14.96
		20		20	7,3														16.06	
		25		25	7,8														17.16	
		32		32	12														26.4	
		40		40	12,5														27.5	
		50		50	26														57.2	
		65		65	27			59.4												
		80		80	29			63.8												
		100		100	61			134.2												
		125		125	65			143.0												
		150		150	95			209.0												
		200		200																

Other pressure ratings (PN25, PN40), connections and body materials on request.