

DC1

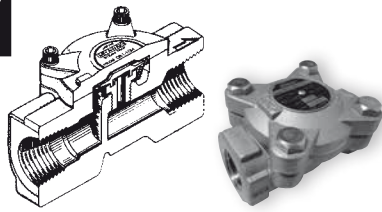

DC2R-16H DC2-16H

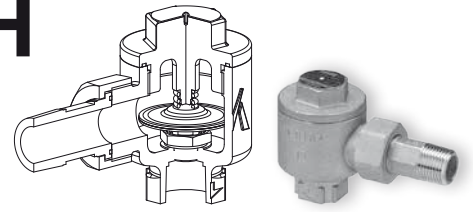

Capacity Chart DC1

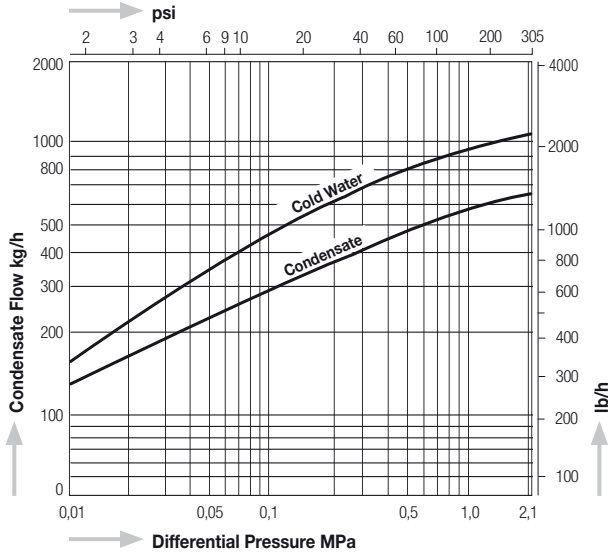

Capacity Chart

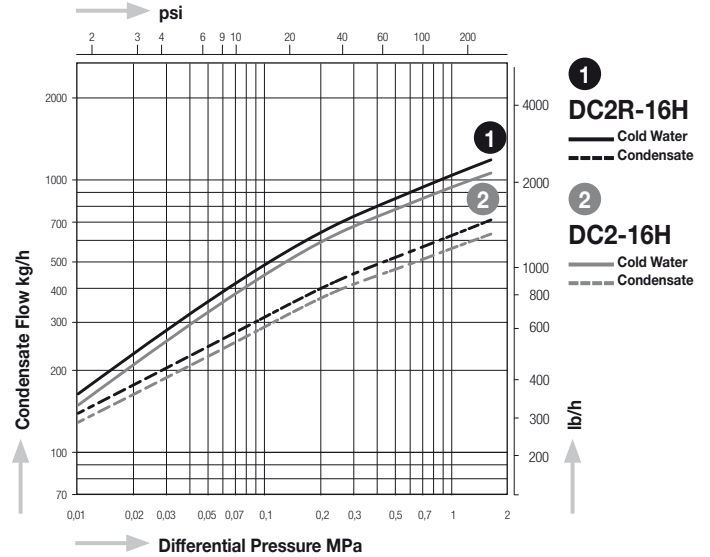

DV1 with Bypass Valve

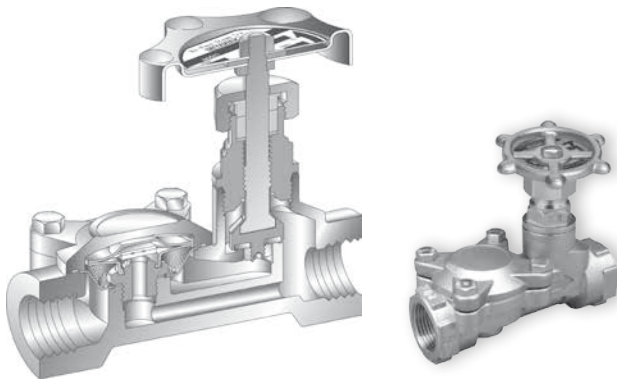

Capacity Chart DV1

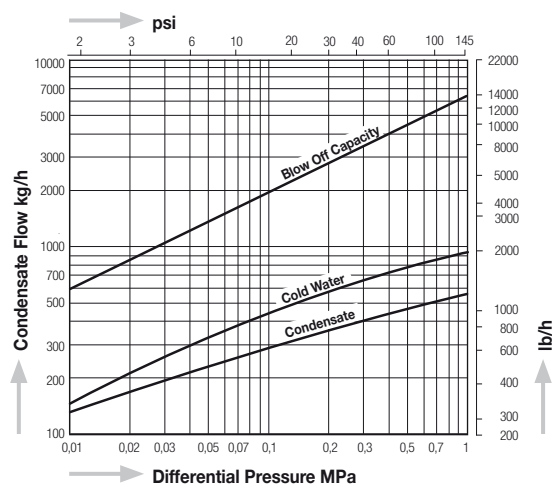

Dimensions

DC1

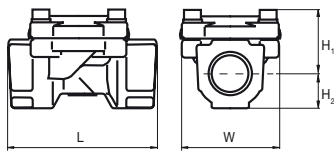

DC2R-16H, DC2-16H

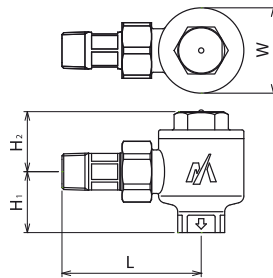

DV1

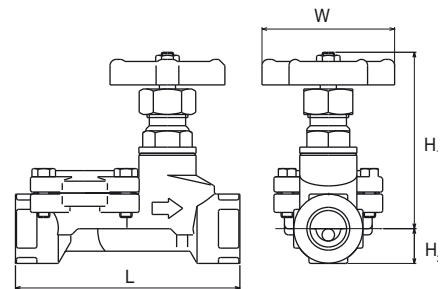

Model	Connections	Size (in)	Max. Operating Pressure		Max. Operating Temperature		Dimensions (mm)				Dimensions (in)				Body Material	Weight	
			MPa	psig	°C	°F	L	H ₁	H ₂	W	L	H ₁	H ₂	W		kg	lb
DC1-21H DC1-21L	Screwed Rc, NPT	1/4", 3/8"	2,1	305	220	428	65	28	11	53	2.6	1.1	0.4	2.1	Stainless Steel SCS13A	0,4	0,9
		1/2", 3/4"					75	30	17	75	3.0	1.2	0.7			0,5	1,1
		1"					80	33	21	80	3.2	1.3	1.4			0,5	1,1
DC2R-16H DC2-16H	Inlet: R Outlet: Rc, NPT	1/2"	1,6	230	220	428	80	35	35	49	3.1	1.4	1.4	1.9		0,7	1,5
DV1-10	Screwed Rc, NPT	1/2", 3/4"	1,0	145	185	365	110	88	17	65	4.3	3.5	0.7	2.6		0,9	1,9