

TBC2, TBC2B

TB1N

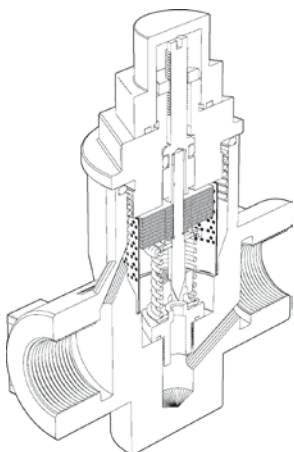

Basic Type with Ball Valve

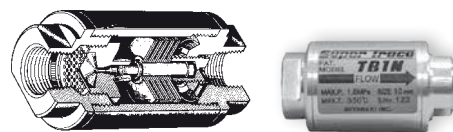

Available option TBC2
with a Ball Valve (TBC2B-C)

Special version TBC2-10

Operating pressure range:
0,5 – 1 MPa (73 – 145 psig)

Standard factory setting:
70°C at 0,5 MPa; 158°F at 73 psig

The dashed line
shows the standard factory setting.

Capacity Chart TBC2/TBC2B-6

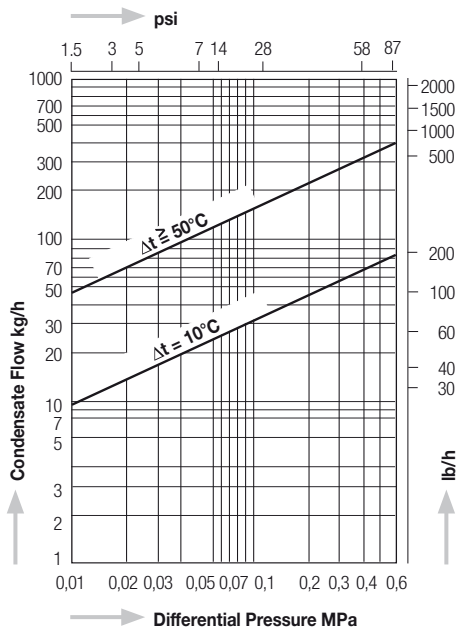

Capacity Chart TB1N

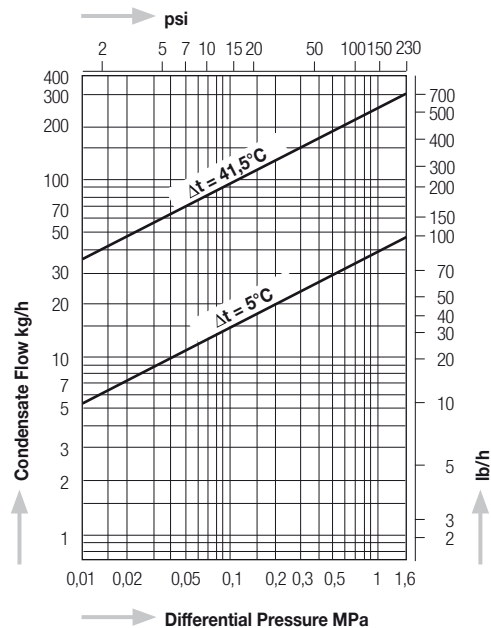

Dimensions TBC2-6

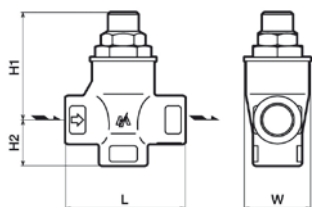

TBC2B-6

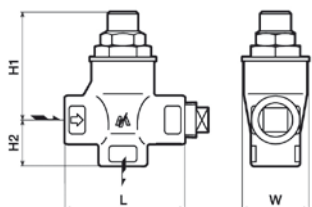

TB1N

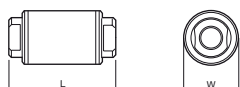

Temperature Stroke Chart TBC2/TBC2B-6

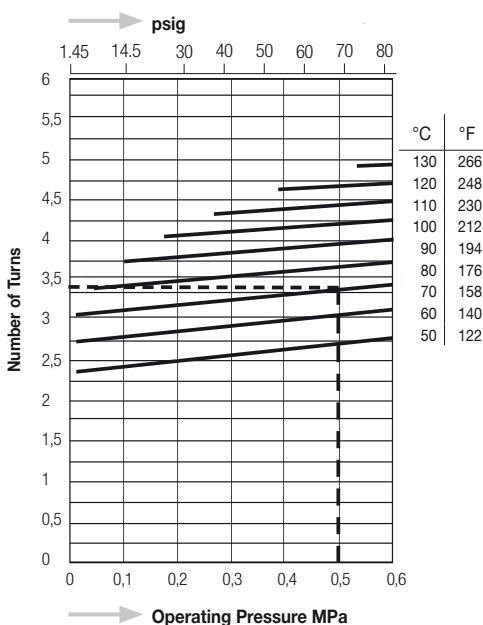

Temperature Stroke Chart TB1N

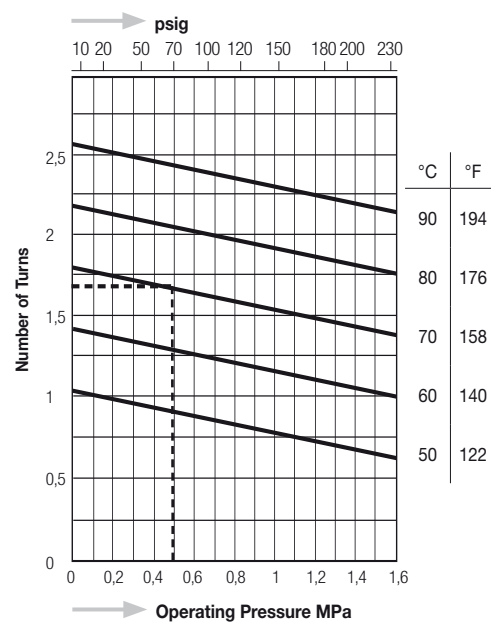

Model	Connections	Size (in)	Max. Operating Pressure		Max. Operating Temperature		Adjustable Range		Dimensions (mm)				Dimensions (in)				Body Material	Weight	
			MPa	psig	°C	°F	°C	°F	L	H1	H2	W	L	H1	H2	W		kg	lb
TBC2-6	Screwed Rc, NPT	¼", ¾"	0,6	87	220	428	50 – 130	122 – 266	60	54	23	33	2.4	2.1	0.9	1.3	Stainless Steel SCS13A	0,33	0.73
TBC2B-6																			
TB1N	Screwed Rc, NPT	¼", ¾"	1,6	230	350	662	50 – 90	122 – 194	70	-	-	38	2.8	-	-	1.5	Carbon Steel S25C	0,35	0.77